



**PAINTBALL LOADER
OWNERS MANUAL**



valken

valken.com



QUICK SET UP GUIDE

- Feeds 30+ BPS
- 220 Ball Capacity
- Ultra Lightweight
- Fast Disassembly
- Quick Change Lid
- Fast Battery Change
- One Touch On/Off
- Uses two 9 Volts

QUICK SET UP GUIDE

1. Install the batteries following the "Battery Installation" instructions on page 2.
2. Mount the V-Max+ loader onto your marker. Make sure the loader feedneck is pushed down as far as possible into your markers feedneck for the most secure fit. Be careful not to over tighten your markers feedneck as it may damage the feedneck of your V-Max+ loader.
3. Turn on your V-Max + loader push and hold the On/Off button located on the rear of the loader under the LED light. You will hear the loader spin if there are no paintballs in the feedneck and the LED light will blink Blue-full battery green-medium battery or red-low battery
4. Fill your V-Max+ loader with paintballs .This feeds the paintballs into the feedneck and breach of your marker and your V-Max+ loader will stop spinning
5. Turn off your V-Max+ Loader by pressing & holding the On/Off button until you see the red light and then release the on-off button. Also your V-Max+ Loader will automatically shut off in one of two ways

A 60 minute power down if eyes are blocked (motor not running)

B 10 minute power down if eyes are unblocked (motor running)

QUICK SET UP GUIDE

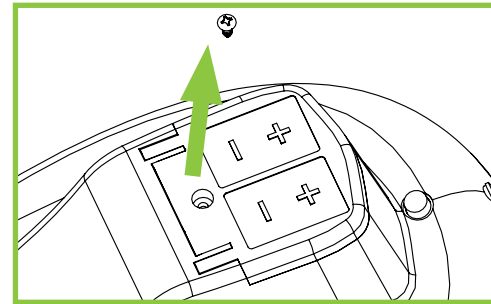

1. Remove the single screw on the underside of the battery door.
NOTE: This screw is optional and not needed to retain the battery door.

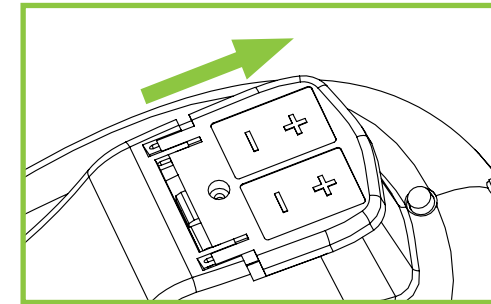

2. Slide the battery door toward the rear of the loader.

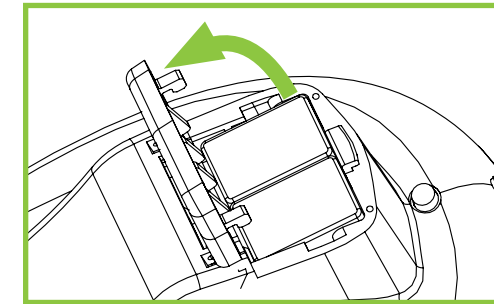

3. Open the battery door and load two 9-Volt batteries according to the diagram on the outside of the battery door. Close the battery door and replace optional screw if desired.

REMOVING THE LID

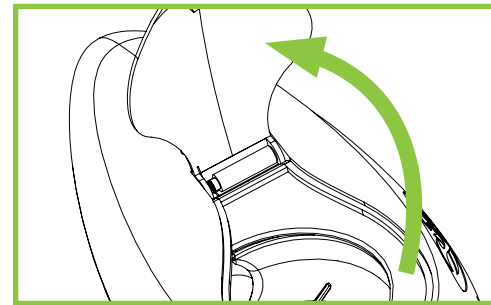

1. Open the lid.

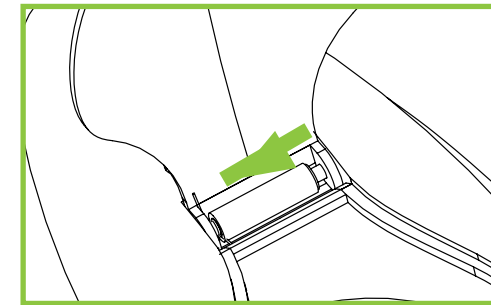

2. Push the hinge pin barrel to the left to disengage the right side of the lid hinge.

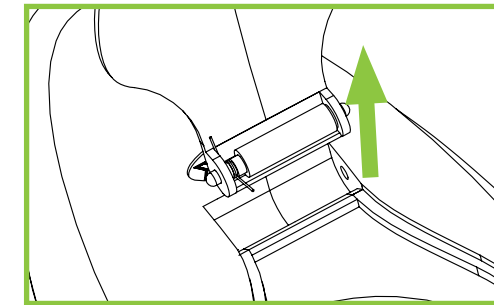

3. Pull the right side of the hinge upward and rotate the left side of the hinge out of the socket in the top shell.

DISASSEMBLY

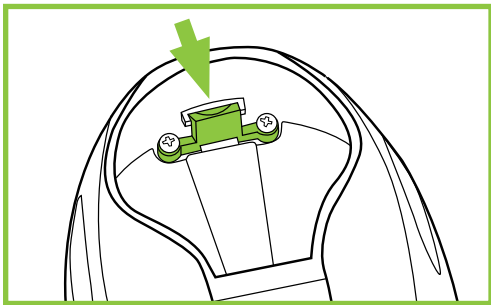

1. Press down on the rear latch on the interior of the loader toward the front of the loader. NOTE: The latch is under constant tension.

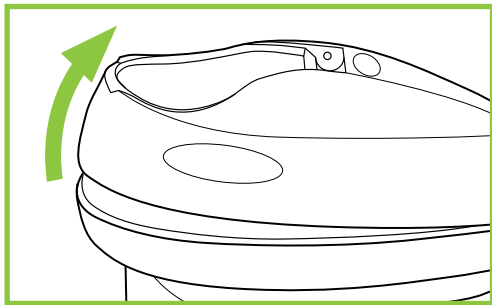

2. Lift the top shell while the rear latch is pressed forward until the top shell is free.

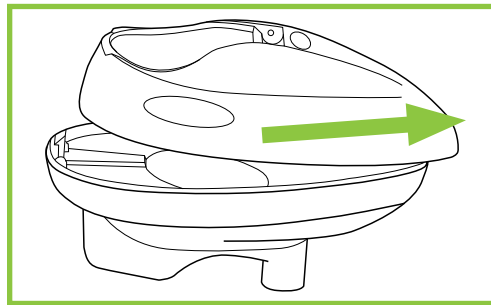

3. Push the top shell forward to disengage the front latch and remove the top shell completely.

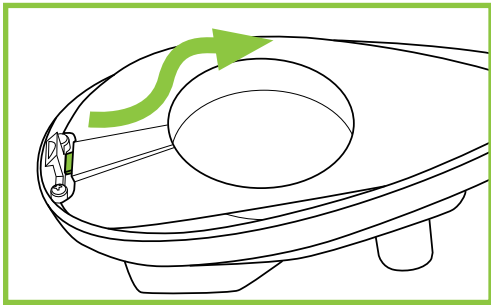

4. Remove the center plate by gripping the inside edge and top of the plate. Pull the tab out from under the rear latch, then the front latch, to free the plate.

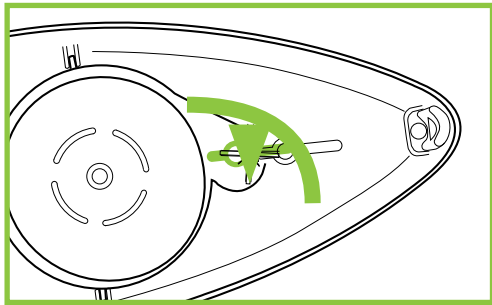

5. Remove the Drive Assembly by rotating the cup latch 90 degrees and disconnecting the wiring harness.

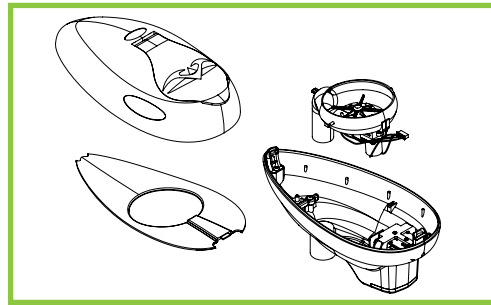

6. Clean any paint from the loader and interior with a non-abrasive cloth. Warning: Do not get the board or electrical components wet.

TROUBLESHOOTING

- V-Max+ Loader will not turn on when pressing the On/Off button.
Check the batteries for correct polarity alignment.
Check the battery strength & replace with fresh, name-brand batteries if necessary.
Contact Valken if further problems persist.
- Breaking paintballs in my V-Max+ Loader.
Make sure to use fresh, quality paintballs in your V-Max+ Loader.
- V-Max+ Loader is slow or not performing as usual.
Make sure the loader is clean and replace the batteries with fresh, name-brand batteries.

CLEANING AND MAINTENANCE

- The V-Max+ Loader should be disassembled and cleaned if:
A paintball is broken in the loader or paint/shell fragments enter the loader.
When dirt or debris enters the loader.
For routine cleaning every few days of play.
- The V-Max+ Loader should be disassembled and cleaned using a non-abrasive cloth. If there is still paint residue, use a damp cloth to remove the remaining paint. Warning: Do not get the board or electrical components wet. Be sure the loader is completely dry before reassembling.
- The V-Max+ Loader requires fresh, quality name-brand batteries to achieve optimum performance. The batteries will need to be regularly replaced to get the highest performance from your V-Max+ Loader.

EXPLODED VIEW

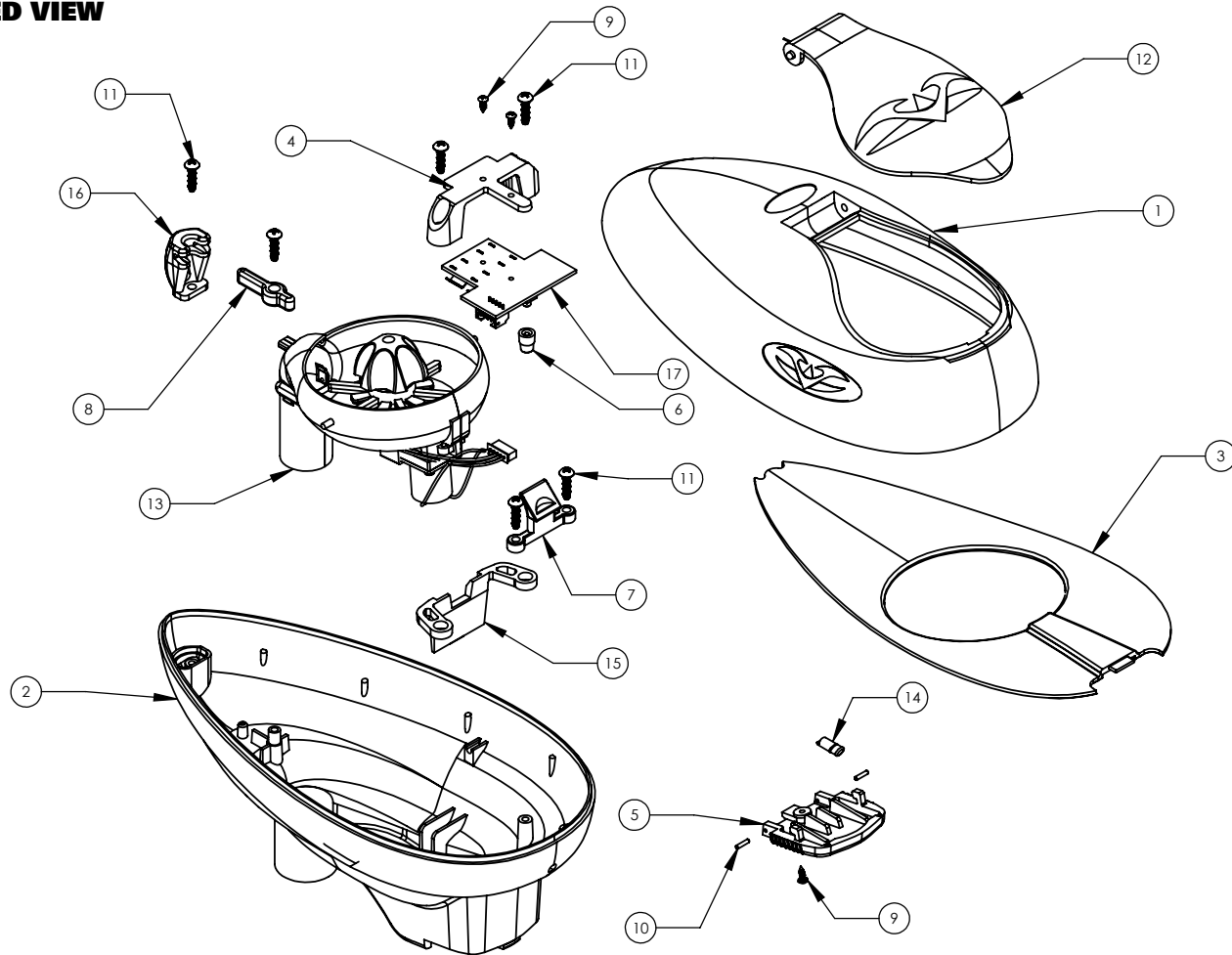

PARTS LIST

ITEM	PART NUMBER	DESCRIPTION	QUANTITY
1	VM-P0001	TOP SHELL	1
2	VM-P0002	BOTTOM SHELL	1
3	VM-P0006	PLATE	1
4	VM-P0009	BATTERY HOLD DOWN	1
5	VM-P0010	BATTERY DOOR	1
6	VM-P0013	ON/OFF BUTTON	1
7	VM-P0014	LATCH HOOK REAR	1
8	VM-P0042	CUP LATCH HOOK REAR	1
9	VM-P0011	#2 X .25 SCREW 8-18 SS	3
10	VM-P0037	.0625 X .270 DOWEL PIN	2
11	VM-P0040	6-19 X .500 SCREW 8-18 SS	6
12	VM-A0005	LID ASSEMBLY	1
13	VM-A0003	DRIVE ASSEMBLY	1
14	VM-P0047	LIGHT PIPE	1
15	VM-P0048	BATTERY GUIDE	1
16	VM-P0051	LATCH HOOK FRONT R 2	1
17	VM-P0001	MAIN IR PCB	1

CLEANING AND MAINTENANCE

- Read, understand and follow all directions in the V-Max+ Loader owner's manual.
- You must wear eye protection that is designed specifically for paintball and meets astm/ce standards and make sure all persons within range wear the same eye protection.
- You should be 18 years old to purchase and/or operate this loader unless an adult is supervising you.
- Make sure you understand all instructions. If you are unsure how to make adjustments, call Valken or your local pro shop for help.



LIMITED WARRANTY

Valken Incorporated provides a limited warranty on the V-MAX+ loader against defects in material and/or workmanship of this product for ninety (90) days from the original date of purchase by the original retail purchaser. A dated copy of the original purchase receipt is required for all warranty claims. In the event that a part is defective, Valken Sports will send out a replacement part free of charge to the original purchaser via surface mail. Regular wear and tear from normal use is not covered under this warranty. Failure of any part due to an accident, abuse, neglect, modification, misuse, operator error, lack of maintenance, or use of parts inconsistent with the use originally intended for the loader as sold are not covered under this warranty. Valken makes no other warranties or guarantees, expressed or implied. Valken limits its sole and exclusive liability and that of its authorized dealers, affiliates, or agents pursuant to this warranty to cover repair or replacement of the defective part. Incidental and consequential damages are expressly excluded hereunder. Valken, its authorized dealers, affiliates, or agents, will not be liable under this warranty, nor under any state or federal law, or the common law or otherwise for any damage or failure, including personal injury, resulting from such use and/or alteration. This warranty gives you specific legal rights, and you may also have other rights which may vary from state to state.

valken.com

Made in China