

TM 219-749-6022

OPERATOR'S MANUAL

TIPPMANN "FACTORY F/A"

**FULLY AUTOMATIC
CO₂ POWERED
PAINTBALL GUN
CALIBER .68**

TIPPMANN

PNEUMATICS, INC.

3518 ADAMS CENTER ROAD
FORT WAYNE, IN 46806

**OPERATOR'S MANUAL
TIPPMANN "FACTORY F/A"
CO₂ POWERED PAINTBALL GUN**

TIPPMANN

PNEUMATICS, INC.

Fort Wayne, Indiana
Warranty & Repair 1 (219) 749-6022

CONGRATULATIONS on your purchase of our Tippmann "FACTORY F/A" Paintball Gun! We believe it to be the most accurate and durable fully automatic paintball gun available at any price, and it will give many years of dependable service if cared for properly.

Please take time to read through this manual thoroughly and become familiar with the Tippmann "FACTORY F/A" parts, operation, and safety precautions before you attempt to load or fire the weapon.

INDEX

Table of Contents	Page
Warning/Safety/	
Liability Statement	1
General	3
Specifications	3
Operating Instructions	
1. CO ₂ Cylinder Connection & Removal	3
2. Safety - SAFE/SEMI/FULL Switch	4
3. Loading / Engaging & Winding Feeder / Unloading	4
4. Firing	5
5. Removing CO ₂ Cylinder	5
Assemblies (Exploded view of gun)	6 & 7
Maintenance	
1-M. Barrel & Feeder Cleaning	5
2-M. Before Storing	8
3-M. After Storage & Before Use	8
4-M. Velocity Adjustment	8
5-M. Feeder Spring	8
6-M. Full Automatic Rate of Fire Adjustment	8
CO ₂ Cylinder Refilling Instructions	10
Warranty & Repair	11

WARNING/LIABILITY STATEMENT

This weapon is classified as a dangerous weapon and is surrendered by Tippmann Pneumatics, Inc. with the understanding that the purchaser assumes all liability resulting from unsafe handling or any action that constitutes a violation of any applicable laws or regulations. Tippmann Pneumatics, Inc. shall not be liable for personal injury or loss of property or life resulting from the use of this weapon under any circumstances, including the intentional, reckless, negligent or accidental discharges.

All information contained in this manual is subject to change without notice, and in no way represents a commitment on the part of Tippmann Pneumatics, Inc. We reserve the right to make changes and improvements to products without incurring any obligation to incorporate such improvements in products previously sold.

SAFETY IS YOUR RESPONSIBILITY!

The ownership of this weapon places upon you the total responsibility of its safe and lawful use. You must observe the same safety precautions as you would any firearm to assure the safety of not only yourself but everyone around you. Outlined here are some general precautions to be aware of, the user should at all times use common sense when using this weapon and always remember that the game of Paintball can only survive and grow if it remains SAFE!

- Handle this and any other weapon as if it was loaded at all times.
- Never point the weapon at anything you do not intend to shoot.
- Always keep the muzzle pointed down or in a safe direction - *Even if you stumble or fall.*
- Do not load or fire this gun or operate its parts like the star feeder until you have read this manual and are familiar with its mechanical operation and handling characteristics.

(SAFETY Continued next page)

SAFETY IS YOUR RESPONSIBILITY - (Continued from page 1)

- Pressurize and load the weapon only when you are using it. Unload and remove CO₂ cylinder immediately after use for safe storage.
- Always wear eye protection in the form of approved goggles or full face mask and never shoot at a person who is not similarly protected.
- Dress for safety when playing the game, avoid any areas of exposed skin especially the face and throat. Even a light layer will absorb some of the impact and protect your skin from cuts produced by the gelatin paintball shell fragments when hit at close ranges.
- Keep exposed flesh away from escaping CO₂ gas when installing or removing bottles or cartridges of gas when installing or removing bottles or cartridges of gas from the weapon or from a filling cylinder. CO₂ gas is very cold and can cause frostbite under certain conditions.
- Use only .68 caliber paintball pellets. Never load or fire any foreign objects.
- Do Not field strip or otherwise disassemble this gun while it is pressurized with gas. Removing the lower receiver while under gas pressure will cause the gun to shoot uncontrollably. Remove CO₂ cylinder or CO₂ cartridge before doing any disassembly.
- Do not look directly into the barrel. Accidental discharge into the eyes may cause permanent injury or death.
- Avoid alcoholic beverages before and during the use of this weapon. Handling guns while under the influence of drugs or alcohol is a criminal disregard for public safety.
- Avoid shooting an opponent at point blank (three feet or less).
- Never fire your weapon at personal property of others, the paintball can stain the paint of automobiles and houses if left on the surface for a few hours.

WARNING: This gun is not a toy nor is it intended for unsupervised use by persons under the age of 18 years. Always keep in mind that the sport of Paintball will be viewed and judged upon your safe and sportsmanlike conduct.

GENERAL

The Tippmann "FACTORY F/A" can be operated as a SEMI or FULL automatic rifle (Cal. 68) and is a modern, small arm produced in accordance with the most advanced manufacturing methods. The Tippmann "FACTORY F/A" is a gas operated rifle which fires from an open bolt, blow-back system. The paintballs are mechanically fed by the Tippmann FACTORY F/A feeder.

SPECIFICATIONS

Model Tippmann "FACTORY F/A"
Caliber68
Action SEMI or FULL Automatic (Open bolt blow-back)
Power CO₂ - standard 9 oz. cylinder
Magazine Capacity 150 shot ammo box
CO₂ Capacity 400+ shots per standard 9 oz. cylinder
Cycle Rate adjustable
Standard Barrel Length 10.5"
Sniper Model Barrel Length 14"
Length - Overall (with Standard barrel & tank) 32"
Weight 4 lbs.
Effective Range 150+ ft.

OPERATING INSTRUCTIONS

1. CO₂ Cylinder Connection

Connect Constant Air Cylinder* with gun unloaded, pull the bolt handle back to the cocked position, pointed in a safe direction and safety on. (Loaded gun may fire one or more rounds when connecting CO₂ tank). Hold gun's forearm grip in left hand. With right hand twist cylinder clockwise into rear end of receiver until tight. The cylinder valve is opened in the last full clockwise twist of the cylinder (stock) into the receiver. Gun should be fully charged and ready to fire. To test, point in a safe direction, release safety and pull trigger. Gun will cycle and fire. (*NOTE - Danger When firing: the bolt handle will cycle forward and back with each shot and operator injury or equipment damage may result if objects including hands, face etc are allowed to obstruct its cycle path.*)

**NOTE: The CO₂ cylinder comes complete with valve and butt plate. The valve stem visible in the end of the valve body is automatically depressed when threaded into the receiver body. This charges the gun with its CO₂ propellant.*

2. Safety

The Bolt Handle When bolt handle is in the forward position the gun will not fire. When the bolt handle is pulled back, the gun is cocked, a paintball is loaded and gun is ready to fire when the Trigger safety is released. Do not uncock gun after it is loaded because it will double feed another paintball when you cock it again.

The SAFE/SEMI/FULL Fire Selection Switch - is located on the side of the gun just above the trigger. To fire the gun: point the gun forward in a safe direction, pull the bolt handle to the back position, move the trigger safety switch from the "SAFE" position to either the SEMI or FULL Automatic setting. The gun will now fire.

3. Loading

With the SAFE/SEMI/FULL fire lever at the "SAFE" position)
• Load .68 caliber ammo into the ammo box through the top loading hole. Do not try to force excessive numbers of paintballs into the ammo box.

• Ready the TPI feeder to feed the gun by winding the loader spring crank handle located on the feeders underside.
• To do so, keep the gun fairly level so the first wind revolution will — "chamber 1 paintball and a second will engage and stop the feeder star wheel from turning" (A minimum of two paintballs are needed to "chamber and engage the star wheel" so that the feeder will start winding up.)

• Once the loader has "chambered and engaged" — Continue to wind the loader spring clockwise figuring approximately 5 shots per revolution with a minimum of 3 revolutions - to a maximum 30 revolutions which produces approximately 150 shots) DO NOT Overwind. Overwinding can cause spring damage and/or loader malfunction!

4. Unloading Ammo & Removing Constant Air Cylinder

Unloading: To unload, remove ammo box or open ammo box then turn gun upside down to shake all balls from ammo box and chamber area. Wind feeder several times and fire gun in a safe direction to clear any balls that may be in barrel or chamber / feeder area. Twist the CO₂ cylinder (stock) 3/4 turn counterclockwise. This closes the cylinder valve. Then fire the remaining CO₂ gas in the gun in a safe direction (approximately 3 shots). Caution: If this procedure is not followed you could destroy your tank o-ring, causing CO₂ cylinder to leak when reconnected to the gun.

4. Firing

- Be sure Feeder is wound because paint balls will not load properly and could be broken if the gun is shot without the feeder spring being wound.
- Be sure the bolt handle is pulled back in the firing position.
- Take gun off safety by moving safety switch from "SAFE" to either SEMI or FULL Automatic position.
 - In SEMI - Each pull/release of the trigger = one shot.
 - In FULL - Each half pull/release of the trigger = one shot
 - Each full pull and hold = multiple shots.

DANGER: Be careful to avoid contact with the bolt handle which will cycle back and forth during the firing cycle.

- Sight in the target and pull the trigger to fire.

5. Removing CO₂ Cylinder For Storage

After unloading paintballs from gun, twist cylinder counterclockwise 3/4 turn. Then, point the gun in a safe direction and pull trigger. (CAUTION: Gun will fire approximately 3 more times until CO₂ charge in receiver is gone.) Now, twist cylinder free from receiver for storing or when not in use. Caution: If you do not follow these procedures, you could destroy your tank o-ring!

MAINTENANCE

1-M. Cleaning Barrel and Feeder

- If a paintball should break in the feeder wipe clean with a dry cloth. Do not get water into wound spring area.
- If a paintball should break in the barrel use cleaning cable suitable for .68 cal barrel and upon completion of play rinse barrel clean with water. (Do not get water into wound spring area.)

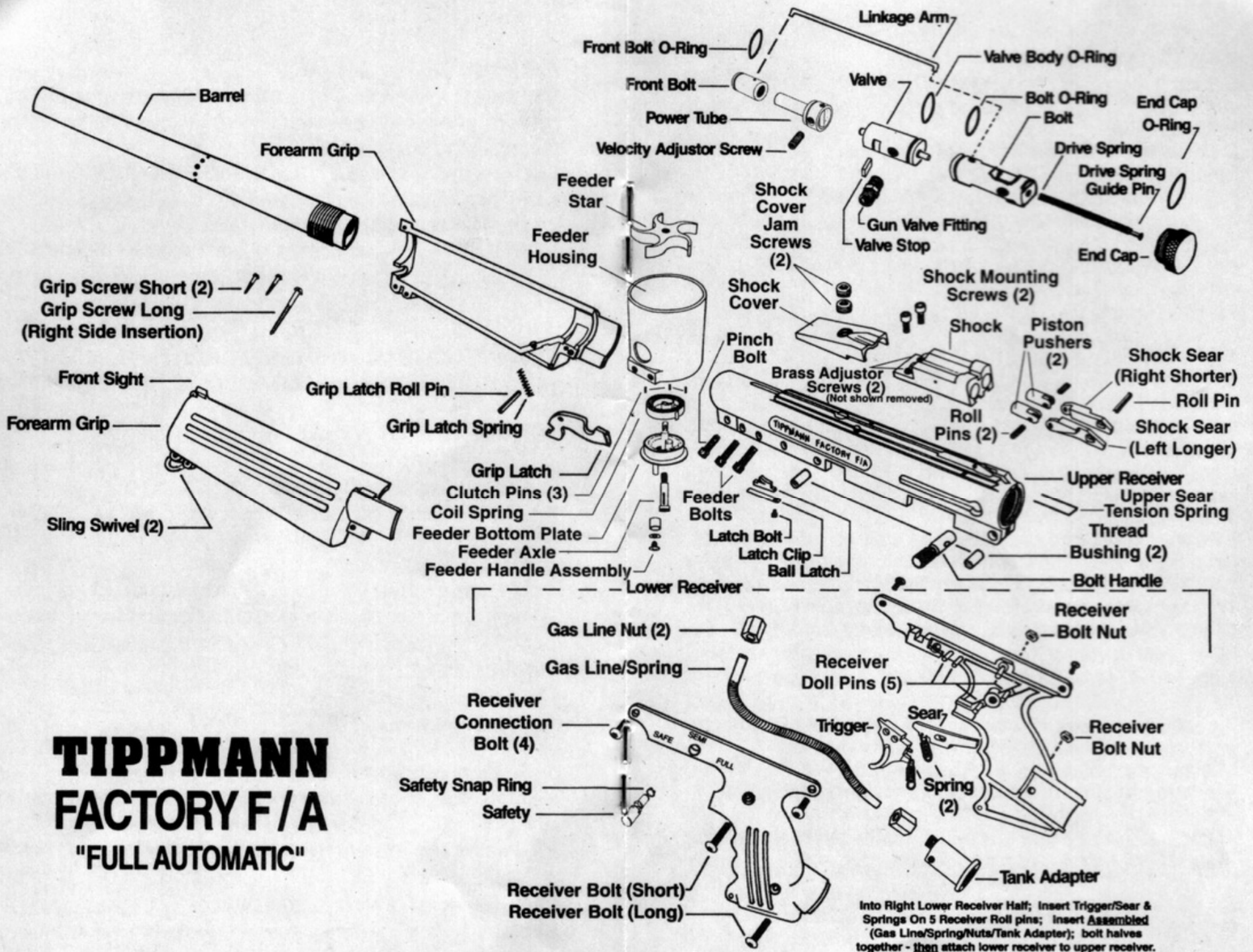

TIPPMANN
FACTORY F/A
 "FULL AUTOMATIC"

Into Right Lower Receiver Half; Insert Trigger/Sear & Springs On 5 Receiver Roll pins; Insert Assembled (Gas Line/Spring/Nuts/Tank Adapter); bolt halves together - then attach lower receiver to upper receiver.

2-M. Before Storing

Before storing gun, remove the CO₂ cylinder. Clean barrel, spray a little light gun oil into the receiver and put bolt handle into the forward position.

3-M. After Storage And Before Use

Before installing the CO₂ cylinder, lubricate the front bolt by putting a few drops of light gun oil into the receiver in front of the rear sight and lubricate the rear bolt by putting a few drops behind the rear sight and in the bolt cocking handle slot. A little lithium grease on the CO₂ cylinder valve o-ring will extend the life of your o-ring.

Recommended Oil - Gun Lubricating Oil such as Hoppes 9 or Household 3 in One oil.

4-M. Velocity Adjustment

To adjust velocity use the 3/32" allen wrench enclosed with the gun. Locate the velocity adjuster screw on the power tube and bushing assembly (The underneath side of your upper receiver). Insert the allen wrench into the velocity adjuster screw and turn it clockwise to decrease velocity / counterclockwise to increase velocity. NOTE: Never completely remove the velocity screw.

5-M. Feeder Spring Lubrication

Feeder coil spring located in the base of the paintball feeder needs oiled approximately every 2,000 rounds with special Tippmann Pneumatics, Inc Feeder Spring Oil. NOTE: This oil should only be used on the coil spring and not on the other parts of your gun.

6-M. Rate of Fire Adjustment FULL Automatic

To adjust rate of fire - make adjustment to the brass rate of fire adjuster screws located in the sight portion of the cover/sight/shock-sear assembly on the upper receiver.

- Unload ammo and remove constant air as on page 4
- Unscrew the rear sight cover locking jam screw and then the inner jam screw.
- Slide the cover forward to reveal the brass rate of fire adjuster screws in the front end of the cover/sight/shock-sears assembly.

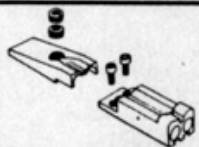

(DO NOT air-up and fire gun with this cover removed, this cover holds the linkage arm in place and personal injury or damage to the gun could result.)

6-M. Rate of Fire Adjustment Continued from page 8

To Adjust Firing Rate

Fine tune the rate of fire with small adjustments to the brass needle valve rate of fire adjustor screw.

- In (clockwise) to slow down.
- Out (counter-clockwise) to speed up.

NOTE: If you make a big adjustment (a full turn is a big adjustment) then the right oil adjustor screw also needs to be readjusted to maintain proper spacing in the shock cylinder.

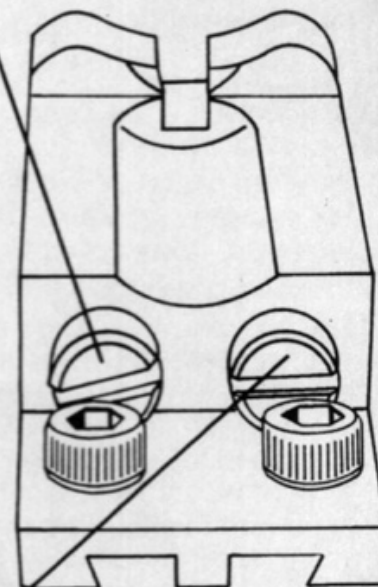

To Adjust Shock

Brass Shock Cylinder Adjustor Screw

Shock cylinder adjustor screw needs adjusted approximately every 2,000 rounds or when a major rate of fire adjustment is made to the other screw.

- Turn the brass shock cylinder oil adjustor screw all the way in (Clockwise). This should prevent the shock sears from fully releasing).
- Next pull the bolt handle back and then release the bolt handle, it should stop before it gets to the normal ready to fire position (and trigger should not work.)
- If the bolt doesn't get stopped before it gets to the normal ready to fire position - the shock cylinder needs oil added and possibly rebuilt.*
- Apply forward pressure to the bolt handle with your thumb while backing the adjustor screw out until the bolt releases from the shock. The screw is now properly adjusted.

DO NOT turn either screw out past the mounting bolts to the point the fluid seal of the shock is broken and air gets into the shock.

**INSTRUCTIONS FOR FILLING
TIPPMANN PNEUMATICS 9 OZ. CO₂
CYLINDERS**

NOTES

- Cylinders must be completely empty to fill properly: To empty, depress pin valve on top of cylinder firmly against small round object until completely empty.
- Bulk cylinders for filling small CO₂ Cylinders must have a siphon tube. Bulk cylinders with siphon tubes are marked with red paint around top of cylinder.
- To fill cylinder, first weigh the TPI 9 oz. cylinder when it is completely empty then install the filling adaptor on bulk cylinder. Then crack hand valve open until the gas in siphon tube escapes and liquid CO₂ appears in the form of white vapor. Next, install empty 9 oz. cylinder into adaptor (hand tight) against rubber washer inside adaptor; then open bulk cylinder hand valve. After approximately 30 seconds, turn hand valve off and remove 9 oz. cylinder.

NOTE: If 9 oz. cylinder was frosty cold when filled it will now have approximately 9 oz. of CO₂ gas in it. If 9 oz. cylinder was warm, it will have approximately 5 oz. of CO₂ gas in it. To fill to 9 oz., depress pin valve on top of cylinder against small round object until completely empty again. This will frost or chill cylinder for final fill. While cylinder is chilled, repeat filling operations. Second filling should now fill cylinder to approximately 9 oz. of CO₂ gas, but it must be weighed.

- To weigh cylinders, first weigh the cylinder when it is completely empty. Then weigh cylinder again when it is filled. Subtract the empty weight from the filled weight to tell the net weight of CO₂ gas in the cylinder. Do not exceed 9 oz. net weight.

NOTE: If 9 oz. cylinder leaks after filling and removing from bulk cylinder, tap valve pin with small ball peen hammer to clear dry ice from the valve seat.

WARNING: Do not overfill 9 oz. cylinders. Do not store full cylinders in a high temperature area. Always use caution when filling and handling high pressure constant air cylinders.

NOTES

TIPPMANN

PNEUMATICS, INC.

WARRANTY AND REPAIR POLICY

Tippmann Pneumatics, Inc. is dedicated to providing you with the ultimate paintball gun and the quality support necessary for the utmost satisfaction in its use. In the event warranty or other non-warranty related repairs are required, we are here for you. We strive to complete within 24 hours of receipt, the necessary repair work for your gun and return it to you via UPS. For assistance with warranty and repair call 1-219-749-6022.

WARRANTY STATEMENT

Tippmann Pneumatics, Inc. warrants that this product is found free from defects in materials and workmanship for a period of 1 year from the original date of purchase by the initial owner/purchaser. On claims submitted as outlined in "WARRANTY OR REPAIR PROCEDURE" Tippmann Pneumatics, Inc. will repair or replace, without charge, any of its guns that have failed through defect in material and workmanship.

WARRANTY OR REPAIR PROCEDURE

For warranty and non-warranty repair, ship or deliver your gun to Tippmann Pneumatics, Inc. postage or delivery charges prepaid, a brief statement regarding the requested repair, your name, address and telephone number where you can be reached during normal business hours, if possible.

SHIP TO:

Tippmann Pneumatics, Inc.
3518 Adams Center Road
Fort Wayne, IN 46806