

FEATURE  
SUPPLEMENT

FOR SL94 EGO  
V1

**SL**



READ AND ADHERE STRICTLY TO ALL OF THE  
SAFETY INSTRUCTIONS AND GUIDELINES IN  
THE EG09 OPERATORS MANUAL!

- 04 SL SHAFT3 BARREL KIT
- 05 SL94 FIXED OUTPUT LPR
- 05 ZICK 2 RAMMER SYSTEM
- 06 ADDITIONAL TRIGGER SYSTEMS
- 07 FSD DELAY PARAMETER
- 07 CURE 3 BOLT SYSTEM
- 08 SERVICE HISTORY

## CONGRATULATIONS,

Thank you for purchasing an *SL-94* Ego marker. The *SL* range represents the very best of *Eclipse* in terms of cutting edge *performance* and *technology* that deliver on our philosophy of refined design and super fast markers that produce *devastating* firepower!

I know you'll be *blown away* with your new Eclipse *SL-94*, but before you use your Marker please read through this *Feature Supplement* as well as the *Ego9 Operation Manual* in its entirety and pay particular attention to all of the *Warnings* and *Safety Guidelines*. If you are missing either the *Feature Supplement* or the *Ego9 Operational Manual* both can be *downloaded* from the *Downloads* page at : [www.planeteclipse.com](http://www.planeteclipse.com)

At the back of this supplement is a section that will allow you to record and track your Markers Service History.

If you have any *questions* or problems turn to the *Dealers & Service Section* in the *Operation Manual* where you will find a list of accredited *Dealer Service Centres* that will be able to help you out or of course you can always contact Nicky T in our *Tech Support Department* directly on: [nick.t@planeteclipse.com](mailto:nick.t@planeteclipse.com)

JACK WOOD - CHIEF ENGINEER

# SL SHAFT3 BARREL KIT

**NOTE: THE BORE SIZE OF YOUR SHAFT 3 MAY VARY ACCORDING TO THE MODEL OF SL YOU HAVE.**

Your Eclipse **SL** comes as standard with an Eclipse SL Shaft 3 barrel.

The barrel screws into the body of the **SL** using a right hand thread meaning that if you hold the **SL** pointing away from you the barrel screws into the body in a counter-clockwise direction.

The barrel comprises of two parts, a barrel back **A** and a barrel front **B**. The two parts are joined together with a left hand thread meaning that if you hold the barrel, with the back nearest you, the front unscrews in a counter-clockwise direction. The bore size of the barrel back is engraved at the end of the barrel back **C**.

On the barrel back there is a **016 NBR 70** o-ring **D** which prevents the barrel from vibrating loose from the SL body when the marker is fired. There is also a **015 NBR 70** o-ring on the barrel front **E** helps with alignment when the two sections are screwed together.

Replace and lubricate these o-rings with Eclipse Grease as necessary.



**NOTE: THE SL WILL ONLY ACCEPT COCKER THREADED BARRELS. DO NOT USE ANY OTHER TYPE OF BARREL THREAD.**

# SL94 FIXED OUTPUT LPR

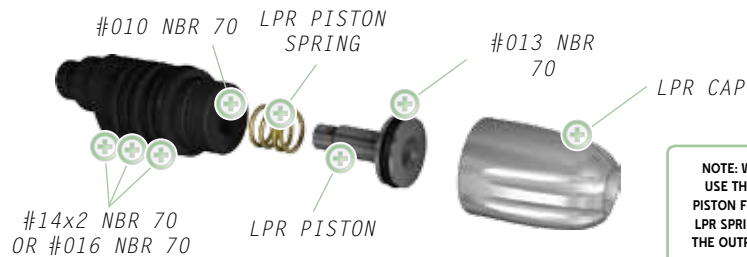

**NOTE: WHEN INSTALLING THE FIXED OUTPUT LPR CAP, DO NOT USE THE SMALL LPR ADJUSTER SPRING IN THE FRONT OF THE PISTON FROM THE ADJUSTABLE LPR CAP. INSTALLING THE SMALL LPR SPRING INTO THE FRONT OF THE FIXED LPR CAP WILL CAUSE THE OUTPUT PRESSURE TO DROP TOO LOW AND CAUSE LOW AND INCONSISTENT VELOCITIES.**

# ZICK 2 RAMMER SYSTEM

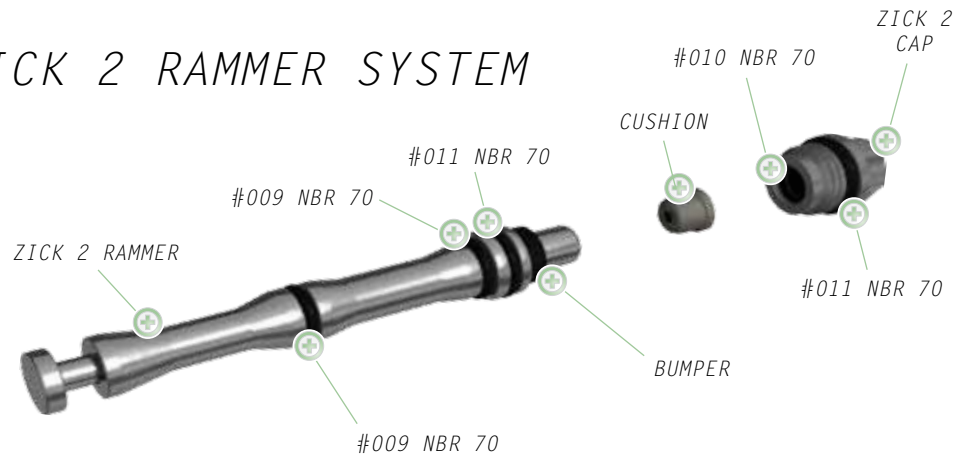

# THE SL94 TRIGGER SYSTEMS



**WARNING: REMOVE ALL PAINTBALLS & DE-GAS YOUR MARKER, DISCHARGING ANY STORED GAS IN A SAFE DIRECTION. DISCONNECT THE BATTERY & REMOVE THE BARREL, LOADER & AIR SYSTEM TO MAKE THE MARKER EASIER & SAFER TO WORK ON.**

The **SL94** comes with two complete trigger systems (bearing carrier, trigger, spring and set-screws) that are interchangeable with the **SL94** frame.

For full details of how to change the trigger system in the **SL94** please consult the **"Ego9 Trigger Assembly"** section in the **Ego9 Operators Manual**. If you have any doubts about how to conduct this procedure then do not hesitate to contact your nearest Eclipse Service Center (see **Eclipse Certified Service Center pages of Ego9 Operators Manual**).

For full details of how to adjust your trigger please refer to the **Setting th Trigger Section** of the **Ego9 Operators Manual**.

## IMPORTANT

When setting the trigger it is **essential** to ensure that the electronic trigger detection is working correctly. When the trigger is fully depressed the Trigger Detection Indicator (**TDI**) should point upwards . When the trigger is fully released the **TDI** should point downwards . For more information, see **Understanding the Trigger Detection Indicator (TDI)** and **Filter Menu** in the **Ego9 Operators Manual**.

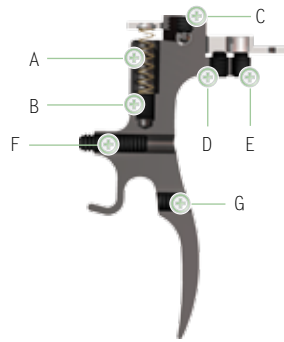

- A** Spring
- B** Spring Return Strength Screw
- C** Trigger Pin Locking Screw
- D** Front Stop Trigger Screw
- E** Magnet Return Strength Screw
- F** Micro Switch Activation Screw
- G** Rear Stop Trigger Screw

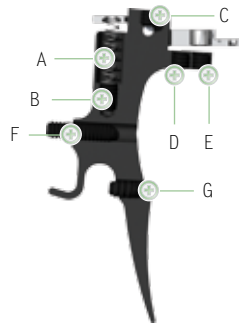

## FSD DLY THE FIRST SHOT DROP OFF DELAY PARAMETER

This parameter sets the amount of time after the last shot before the **FSD COMP** is used on the next shot. The first shot after powering on the **SL94** will always have **FSD COMP**. This parameter can be set between **30** and **240** seconds in **10** second increments.

**NOTE: FOR FULL INSTRUCTIONS OF HOW TO ADJUST THE FSD DLY PARAMETER PLEASE CONSULT THE ADVANCED SET-UP SECTION OF THE EGO9 OPERATORS MANUAL.**

## CURE 3 BOLT SYSTEM

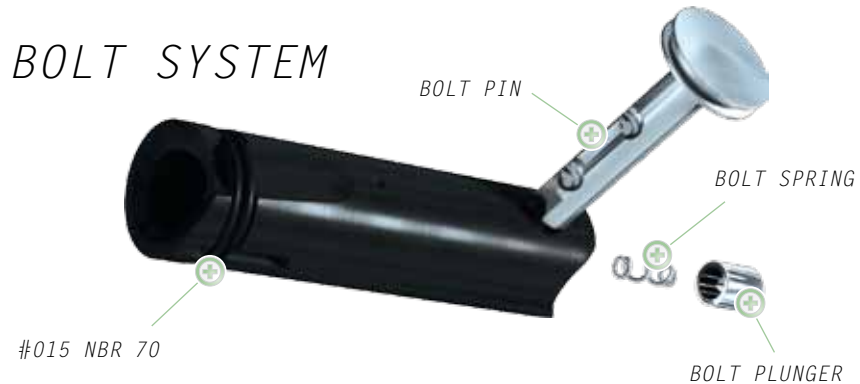

<i>SERVICE HISTORY</i>	
<i>SERVICE STAMP:</i>	<i>WORK UNDERTAKEN:</i>
	<i>DATE:</i> <i>SIGNATURE:</i>
<i>SERVICE STAMP:</i>	<i>WORK UNDERTAKEN:</i>
	<i>DATE:</i> <i>SIGNATURE:</i>
<i>SERVICE STAMP:</i>	<i>WORK UNDERTAKEN:</i>
	<i>DATE:</i> <i>SIGNATURE:</i>

<i>SERVICE HISTORY</i>	
<i>SERVICE STAMP:</i>	<i>WORK UNDERTAKEN:</i>
	<i>DATE:</i> <i>SIGNATURE:</i>
<i>SERVICE STAMP:</i>	<i>WORK UNDERTAKEN:</i>
	<i>DATE:</i> <i>SIGNATURE:</i>
<i>SERVICE STAMP:</i>	<i>WORK UNDERTAKEN:</i>
	<i>DATE:</i> <i>SIGNATURE:</i>

NOTES

NOTES



### ***UK & EUROPE***

Units 5-8 Southfield Ind Est, Praed Road Trafford Park, Manchester, England, M171SJ  
Call: +44 (0)161 872 5572

### ***USA & CANADA***

Suite 4, 84 Cutler Street, Warren, Rhode Island, 02885, USA  
Call: 401 247 9061

Licensed under one or more of the following patents:

US 6311682, 6615814, 5881707, 5967133, 6035843, 6474326B1, 6637421B2 UK GB 234270, GB 2345953

© Copyright 2009 Planet Eclipse Ltd. SL, and the SL94 device are either trademarks, design trademarks or registered trademarks of Planet Eclipse Ltd.

***SL09V1***